

**CURVE INFORMATION**

Name	C100	Point	North	East	Name	C109	Point	North	East
R	109.700	PC	5936961.284	57018.148	R	7.500	PC	5936842.094	57195.100
Lc	29.040	PI	5936961.114	57003.543	Lc	3.033	PI	5936843.630	57195.040
Delta	15°10'03"	CC	5936851.591	57019.422	Delta	23°10'05"	CC	5936841.801	57187.606
T	14.606	PT	5936957.129	56989.492	T	1.537	PT	5936845.019	57194.380
Name	C101	Point	North	East	Name	C110	Point	North	East
R	100.200	PC	5936951.785	57018.258	R	8.000	PC	5936845.340	57202.584
Lc	26.525	PI	5936951.630	57004.918	Lc	3.235	PI	5936846.872	57203.169
Delta	15°10'03"	CC	5936851.591	57019.422	Delta	23°10'05"	CC	5936848.197	57195.111
T	13.341	PT	5936947.990	56992.084	T	1.640	PT	5936848.510	57203.105
Name	C102	Point	North	East	Name	C111	Point	North	East
R	18.000	PC	5936963.156	57179.308	R	7.500	PC	5936845.340	57202.584
Lc	11.880	PI	5936963.227	57185.473	Lc	3.033	PI	5936843.904	57202.035
Delta	37°48'52"	CC	5936981.154	57179.099	Delta	23°10'05"	CC	5936842.661	57209.589
T	6.165	PT	5936967.064	57190.300	T	1.537	PT	5936842.368	57202.095
Name	C103	Point	North	East	Name	C112	Point	North	East
R	10.000	PC	5936943.757	57192.163	R	8.000	PC	5936833.786	57186.817
Lc	15.754	PI	5936953.804	57192.093	Lc	13.168	PI	5936833.475	57195.437
Delta	90°15'56"	CC	5936943.688	57182.164	Delta	94°18'40"	CC	5936841.781	57187.106
T	10.046	PT	5936953.687	57182.047	T	8.626	PT	5936842.094	57195.100
Name	C104	Point	North	East	Name	C113	Point	North	East
R	12.000	PC	5936949.487	57206.544	R	10.000	PC	5936814.733	57194.920
Lc	35.913	PI	5937067.216	57316.299	Lc	14.956	PI	5936824.000	57194.557
Delta	171°28'20"	CC	5936957.670	57197.766	Delta	85°41'20"	CC	5936814.342	57184.928
T	160.954	PT	5936967.064	57190.300	T	9.275	PT	5936824.335	57185.289
Name	C105	Point	North	East	Name	C114	Point	North	East
R	18.000	PC	5936949.487	57206.544	R	7.500	PC	5936833.221	57202.453
Lc	13.632	PI	5936944.248	57201.660	Lc	3.033	PI	5936831.685	57202.513
Delta	43°23'32"	CC	5936937.213	57219.710	Delta	23°10'05"	CC	5936833.515	57209.947
T	7.162	PT	5936937.087	57201.710	T	1.537	PT	5936830.296	57203.172
Name	C106	Point	North	East	Name	C115	Point	North	East
R	1255.700	PC	5936892.631	57192.520	R	8.000	PC	5936827.177	57203.940
Lc	40.355	PI	5936872.453	57192.661	Lc	3.235	PI	5936828.815	57203.876
Delta	1°50'29"	CC	5936901.395	58448.190	Delta	23°10'05"	CC	5936826.864	57195.946
T	20.179	PT	5936852.289	57193.450	T	1.640	PT	5936830.296	57203.172
Name	C107	Point	North	East	Name	C116	Point	North	East
R	1246.200	PC	5936892.698	57202.020	R	628.800	PC	5936836.558	57110.111
Lc	40.050	PI	5936872.672	57202.160	Lc	50.487	PI	5936837.471	57084.871
Delta	1°50'29"	CC	5936901.395	58448.190	Delta	4°36'01"	CC	5936208.169	57087.402
T	20.027	PT	5936852.660	57202.943	T	25.257	PT	5936836.356	57059.639
Name	C108	Point	North	East	Name	C117	Point	North	East
R	8.000	PC	5936848.139	57193.613	R	619.300	PC	5936827.065	57109.768
Lc	3.235	PI	5936846.500	57193.677	Lc	49.724	PI	5936827.963	57084.909
Delta	23°10'05"	CC	5936848.451	57201.606	Delta	4°36'01"	CC	5936208.169	57087.402
T	1.640	PT	5936845.019	57194.380	T	24.875	PT	5936826.865	57060.058

**NOTES**

- NO DRIVEWAYS PERMITTED WITHIN 1.5m OF STREET FURNITURE.
- APPROVED DRIVEWAY LOCATIONS ARE SHOWN. NO DEVIATION PERMITTED WITHOUT PRIOR APPROVAL OF THE COUNTY ENGINEER.
- CURB TRANSITION FROM ROLLED FACE TO STRAIGHT FACE ARE SHOWN THUS: SF → RF

**ROADWAY STRUCTURES**

LOCAL ROADWAYS	
40mm	10mm LT ASPHALT
75mm	10mm LT ASPHALT
200mm	20mm GRANULAR BASE COURSE
150mm	SUBGRADE PREP WITH 10kg OF CEMENT STABILIZATION

TEMPORARY GRAVEL CONNECTION	
150mm	20mm GRANULAR BASE COURSE
	GEOTEXTILE FABRIC
150mm	SUBGRADE PREP

**TRAFFIC SIGNS**

TO STRATHCONA COUNTY STANDARDS

- ① a HARVEST CRES
- b HAYFIELD GROVE
- ② a HARVEST CRES
- b HAYFIELD GROVE

**SIGNAGE TABLE OF MATERIALS**

ITEM	TYPE	NUMBER
	YIELD	1
	STREET BLADE TEXT: HARVEST CRES	1
	HAYFIELD GROVE	1

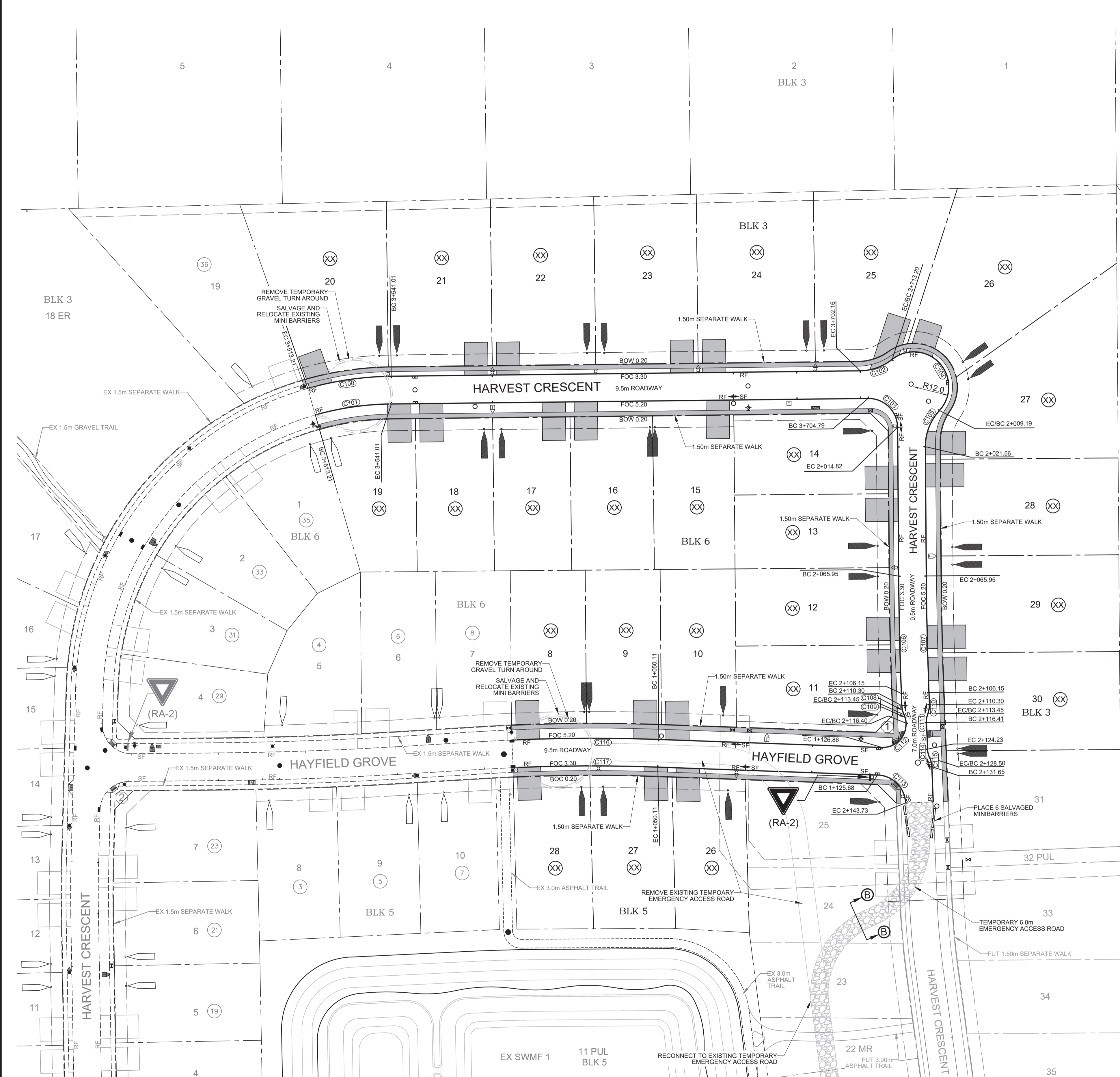
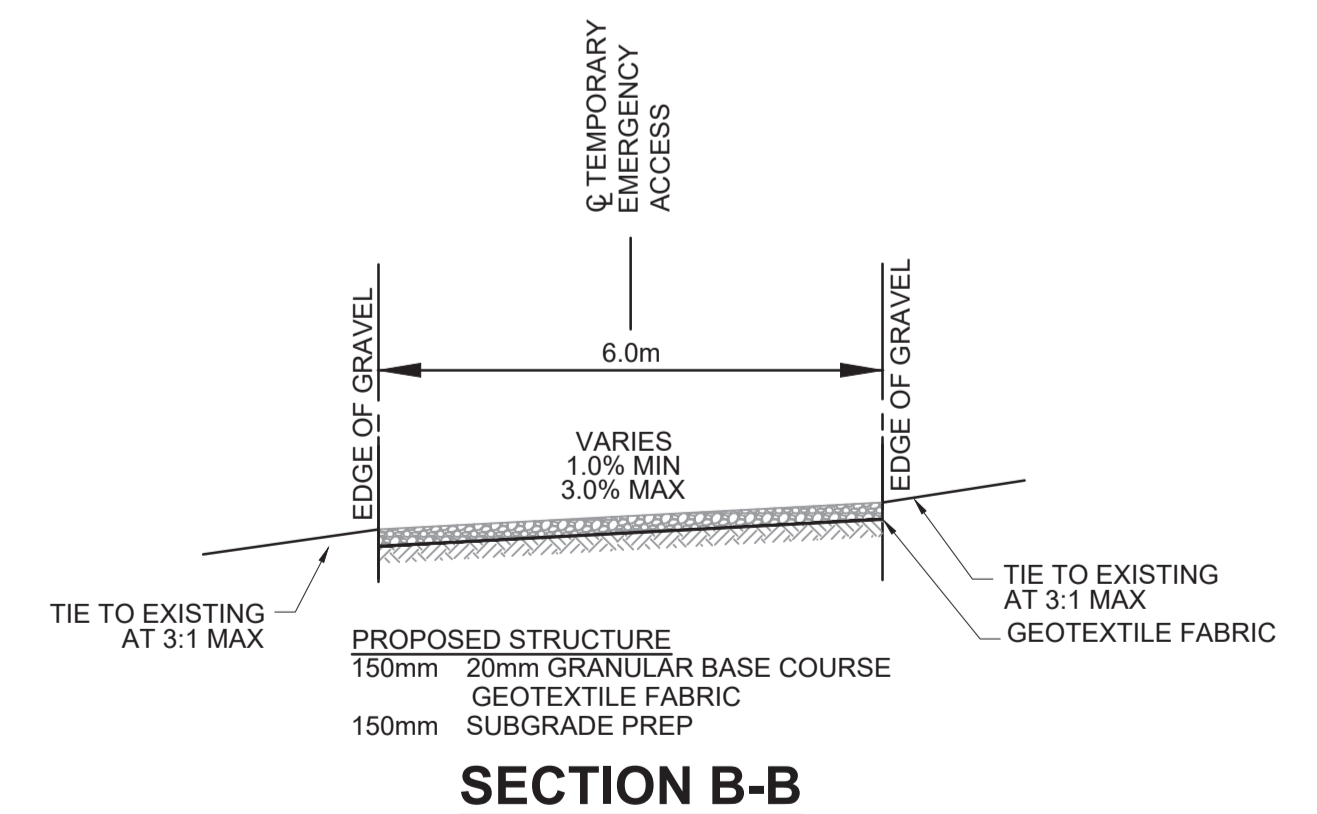

EXISTING	PROPOSED	FUTURE	EXISTING	PROPOSED	EXISTING	PROPOSED

NO.	REVISION	DATE	BY
4.	ISSUED FOR CONSTRUCTION DRAWINGS	MAY 17/21	NAS
3.	2nd SUBMISSION FOR COUNTY REVIEW	MAY 03/21	KBA
2.	REVISIONS PER COUNTY COMMENTS	APR 28/21	KBA
1.	1st SUBMISSION FOR COUNTY/CLIENT REVIEW	FEB 08/21	NAS

**Al-Terra Engineering Ltd.**

**ROAD OVERALL, STREET FURNITURE, & ADDRESSING PLAN**

DESIGN:	NAS	CHECKED:	NAS	JOB NO.:	6619
DRAWN BY:	CM	APPROVED:	KBA	DRAWING NO.:	
SCALE:	1:750	DATE:	FEBRUARY 2021		6619-207&221

**ARDROSSAN ESTATES STAGE 3**  
BY  
**ARDROSSAN LAND CORPORATION**  
IN  
 **STRATHCONA COUNTY**