

ROADWAY STRUCTURES

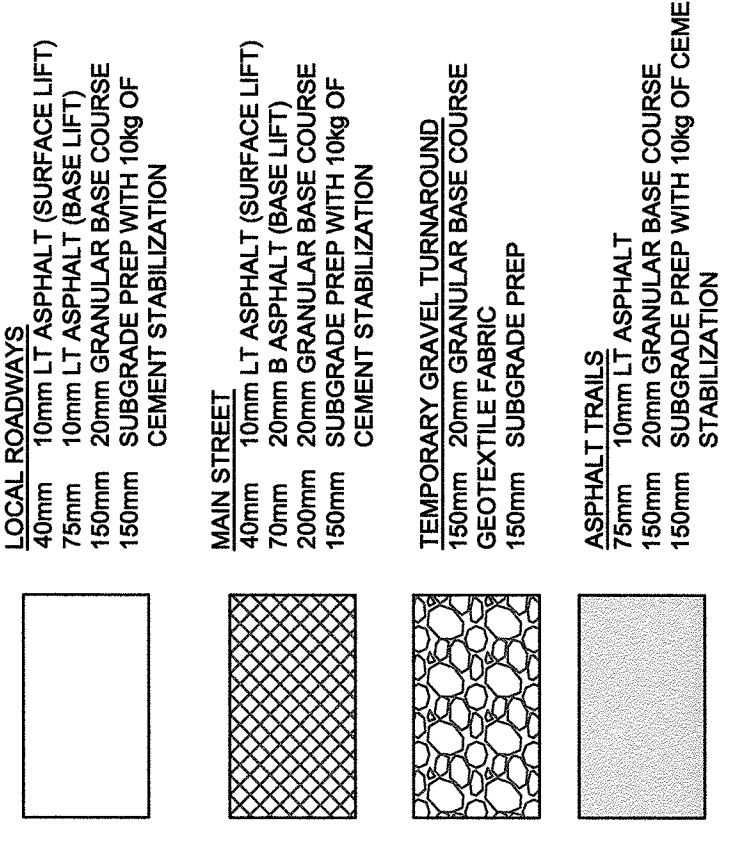

TRAFFIC SIGNS

TO STRATHCONA COUNTY STANDARDS

- a HARVEST CRESCENT
- b HAYFIELD GROVE
- a HAVEN LINK
- b HUNDRED ACRE GATE
- a MAIN STREET
- b HUNDRED ACRE GATE
- a MAIN STREET
- b TOWNSHIP ROAD 531

- FOR TRAIL SIGNAGE AND DETAILS SEE LANDSCAPING DRAWINGS 6614-226.03 & 6614-226.05

LINEPAINTING & PAVEMENT MARKINGS

TO STRATHCONA COUNTY STANDARDS

- ALL STREET MARKINGS TO BE PAINT AT CCC
- ALL STREET MARKINGS ARE TO BE PF TYPE INLAY THERMOPLASTIC AT PAC
- NO DRIVEWAYS PERMITTED WITHIN 1.5m OF STREET FURNITURE
- ALL DRIVEWAY LOCATIONS ARE SHOWN, NO DEVIATION PERMITTED WITHOUT PRIOR APPROVAL OF THE COUNTY ENGINEER.
- CURB TRANSITION FROM ROLLED FACE TO STRAIGHT FACE ARE SHOWN THIS: SF → RF

⑤ SOLID YELLOW CENTERLINE 0.10m WIDE

NOTES

- NO DRIVEWAYS PERMITTED WITHIN 1.5m OF STREET FURNITURE
- ALL DRIVEWAY LOCATIONS ARE SHOWN, NO DEVIATION PERMITTED WITHOUT PRIOR APPROVAL OF THE COUNTY ENGINEER.
- CURB TRANSITION FROM ROLLED FACE TO STRAIGHT FACE ARE SHOWN THIS: SF → RF

FENCING

- SEE LANDSCAPING DRAWINGS (6614-226.01, 6614-226.02, 6614-226.03, 6614-226.04, & 6614-226.05) FOR FENCING LOCATIONS AND DETAILS

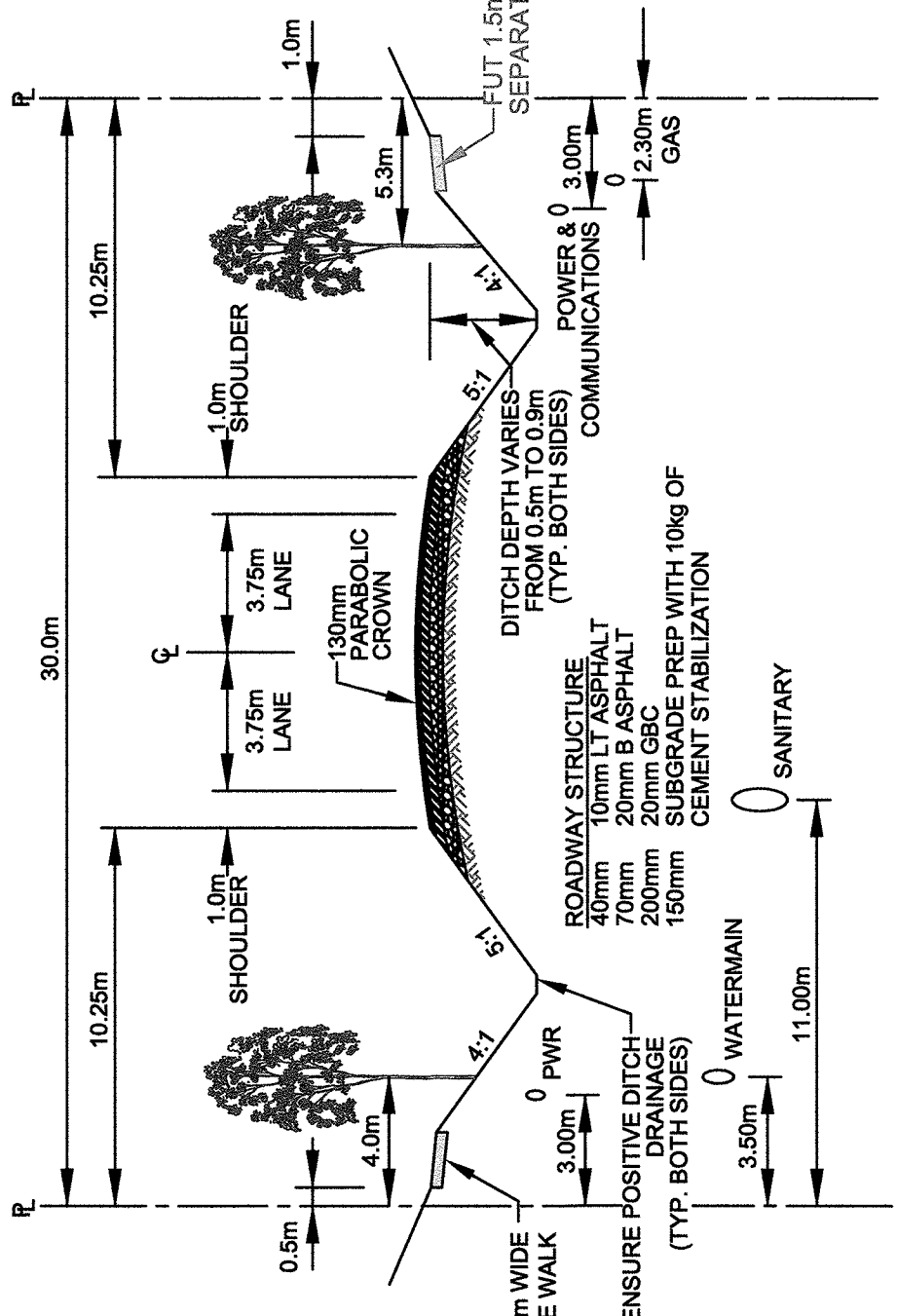

SECTION C-C

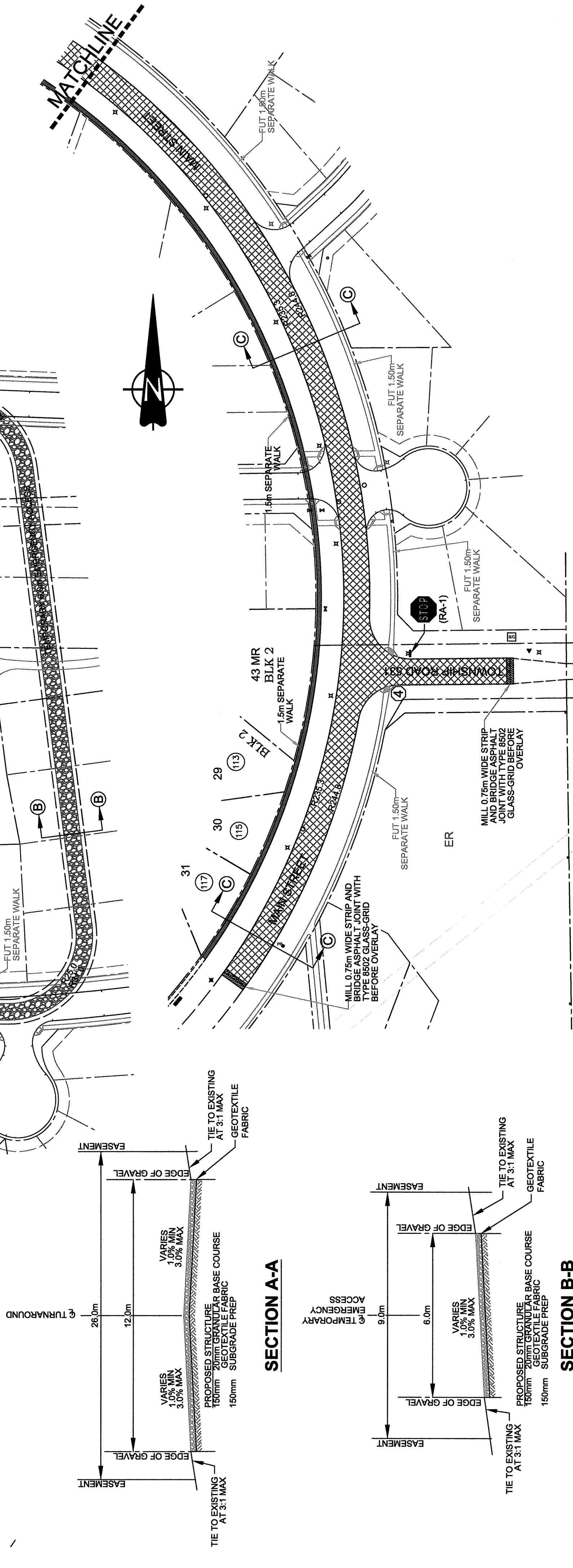

SECTION A-A

SECTION B-B

AL-Terra

ROAD OVERALL, STREET FURNITURE, & ADDRESSING PLAN

DESIGN: KBA CHECKED: KBA JOB NO: 6614
 DRAWN BY: VM APPROVED: LIB DRAWING NO. 6614-207/221
 SCALE: 1:1000 DATE: NOVEMBER 2016

ARROSSAN ESTATES STAGE 2
 BY
 ARROSSAN LAND CORPORATION
 IN
 STRATHCONA COUNTY

PERMIT TO PRACTICE
 AL-Terra Engineering Ltd.
 Signature: [Signature]
 Date: MAY 10, 2017
 PERMIT NUMBER: P 2104
 The Association of Professional Engineers, Geologists and Geophysicists of Alberta

NO.	REVISION	DATE	BY
1.	1st SUBMISSION FOR COUNTY/CLIENT REVIEW	NOV 18/16	KBA
2.	REVISED PER COUNTY COMMENTS	JAN 17/17	KBA
3.	2nd SUBMISSION FOR COUNTY REVIEW	FEB 10/17	KBA
4.	REVISED PER COUNTY COMMENTS	MAR 27/17	KBA
5.	REVISED PER COUNTY COMMENTS	MAY 05/17	KBA
6.	UP & SF APPROVED BY COUNTY	MAY 05/17	KBA
7.	ISSUED FOR CONSTRUCTION (FC DWGS)	MAY 10/17	KBA

LEGEND

EXISTING	PROPERTY LINE	PROPOSED	PROPERTY LINE
EXISTING	RIGHT OF WAY LINE	PROPOSED	RIGHT OF WAY LINE
EXISTING	CURB AND GUTTER	PROPOSED	CURB AND GUTTER
EXISTING	SEPARATE WALK	PROPOSED	SEPARATE WALK
EXISTING	ASPHALT TRAIL	PROPOSED	ASPHALT TRAIL
EXISTING	STREET ADDRESS	PROPOSED	STREET ADDRESS
EXISTING	STREET NAME SIGNS	PROPOSED	STREET NAME SIGNS

EXISTING

- VALVE
- HYDRANT
- CURB STOP
- CATCH BASIN
- TRANSFORMER
- FEDERAL HIGHWAY
- POWER POLES
- T-BOLLARDS
- MAILBOX
- SWITCHING CUBICAL

PROPOSED

- VALVE
- HYDRANT
- CURB STOP
- CATCH BASIN
- TRANSFORMER
- FEDERAL HIGHWAY
- POWER POLES
- T-BOLLARDS
- MAILBOX
- SWITCHING CUBICAL

EXISTING

- DRIVEWAY LOCATION
- WATER, SANITARY & STORM SERVICE LOCATIONS

PROPOSED

- DRIVEWAY LOCATION
- WATER, SANITARY & STORM SERVICE LOCATIONS